

ABSTANDSFLÄCHEN LEGENDE H x 0,4

	= H1	= 6.26m x 0.4 = 2.50m
	= H1	= 7.28m x 0.4 = 2.91m
	= H2	= 6.26m x 0.4 = 2.50m
	= H2	= 7.05m x 0.4 = 2.82m
	= H3	= 5.25m x 0.4 = 2.10m
	= H3	= 5.33m x 0.4 = 2.13m
	= H4	= 5.23m x 0.4 = 2.09m
	= H4	= 5.33m x 0.4 = 2.13m
	= H5	= 4.74m x 0.4 = 1.90m
	= H5	= 4.70m x 0.4 = 1.88m
	= H6	= 7.22m x 0.4 = 2.89m
	= H6	= 8.16m x 0.4 = 3.26m
	= H7	= 7.94m x 0.4 = 3.18m
	= H7	= 7.33m x 0.4 = 2.93m

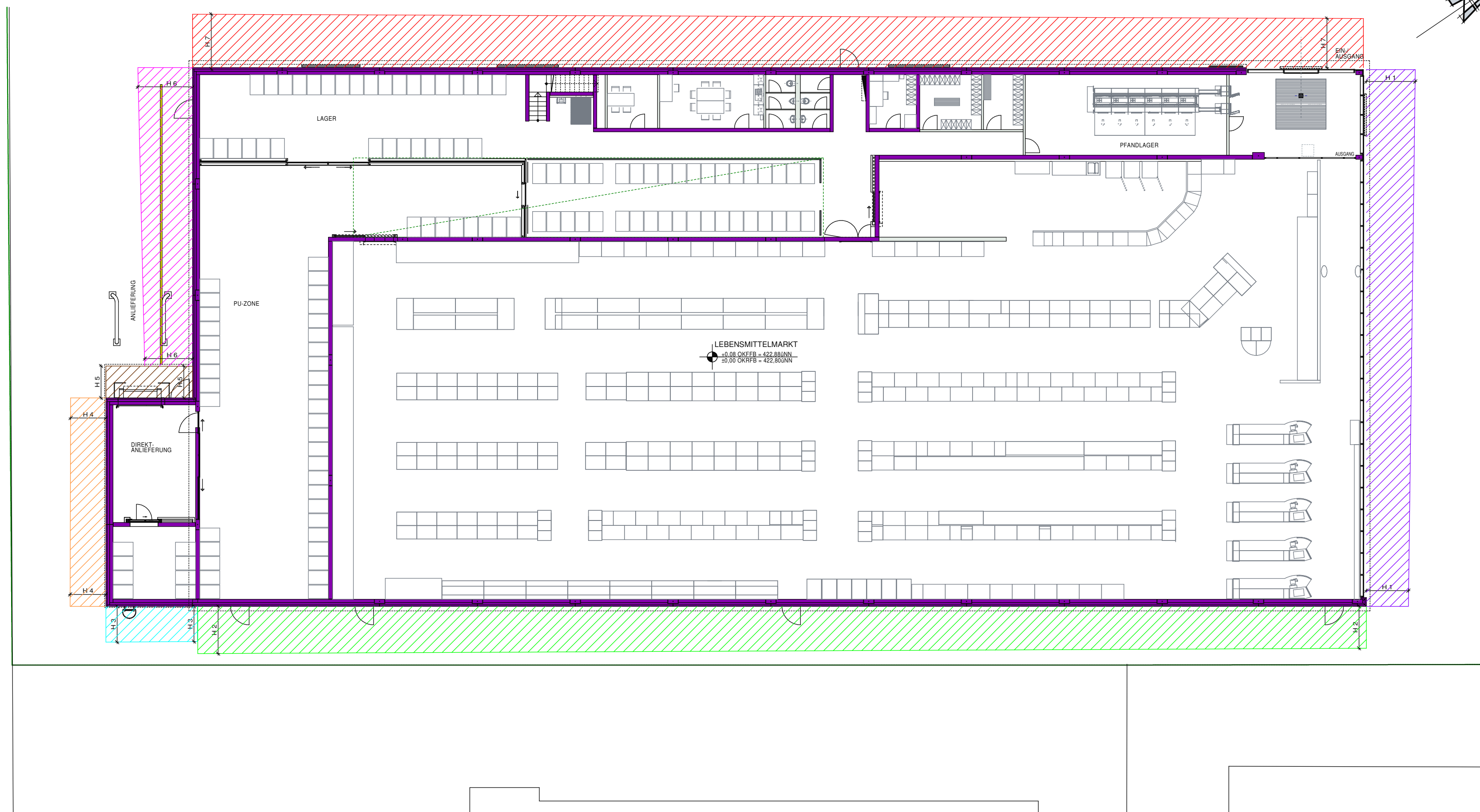

ERRICHTUNG EINES LEBENSMITTELMARKTES
IN 91567 HERRIEDEN, INDUSTRIESTRASSE 7

LIDL DIENSTLEISTUNG GmbH & Co. KG
VERTRETEN DURCH:

LIDL VERTRIEBS GmbH & Co. KG

MAX-EYTH-STR. 13
74638 WALDENBURG

ABSTANDSFLÄCHEN M 1:200

BAUHERR:

LIDL Vertriebs GmbH & Co. KG
MAX-EYTH-STR. 13
74638 WALDENBURG

NACHBARN:

FLUR NR. 1213 IVMG GmbH & Co. Objekt 11 KG
71384 WEINSTADT, POSTSTR. 15/2

FLUR NR. 1213/3 TOLKSDORF GERDA
91567 HERRIEDEN, INDUSTRIESTR. 9

FLUR NR. 1213/3 TOLKSDORF THORSTEN
91567 HERRIEDEN, TAUBERZELLER WEG 6

ANSBACH IM NOVEMBER 2021
PLANFERTIGER:

PLANUNG SERVICE GmbH
Ingenieure und Architekten
91522 Ansbach Tel.: 09 81- 97 18 80
Louis-Schmeizer-Straße 8 Fax: 09 81- 97 18 910